

Data sheet - Support roller STO 6TN (crowned, with inner ring)

Designation	STO 6TN
Type	crowned
D [mm]	19
d [mm]	6
F, Fw * [mm max.]	10
B1 [mm]	10
B [mm]	9,8
d1 [mm]	13
r [mm]	0,3
Dynamic load Crw [N]	3750
Static load C0rw [N]	4500
Speed limit [min-1]	20000

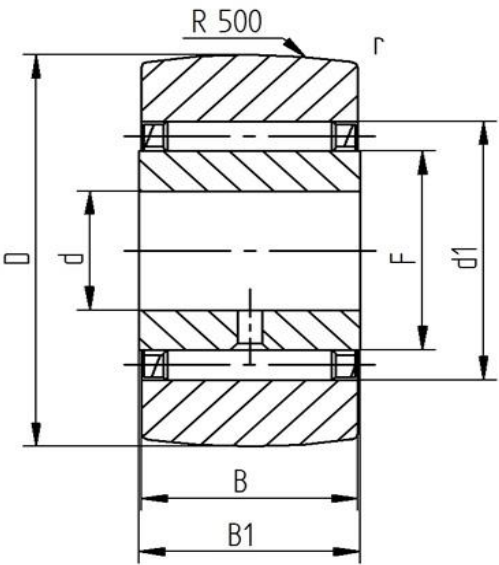

Every specification has been edited and verified carefully. STI Bearings GmbH assumes no liability for potential errors or incompleteness. Technical modifications are subject of changes.
 © 2020 by STI Bearings GmbH
 Reproduction, even excerpts, only with our approval.